

make your next event

A REAL EXPERIENCE

Choose Esplanade Hotel Fremantle – by Rydges for your next function, meeting, gala dinner or networking event.

The vibrant city of Fremantle blends old with new, creating an enriching cultural experience only 20 minutes from the Perth CBD and 30 minutes from Perth airports. Maritime, convict and colonial history can be explored while buzzing markets, lively bars and casual street cafés give you a taste of the 'Freo' lifestyle.

The Esplanade Hotel Fremantle is an ideal place to visit and a dynamic hub to host your next team get together, strategy day, product launch or awards dinner. Home to one of Western Australia's largest convention and exhibition facilities, the Hotel offers an outstanding choice of venues perfect for all types of events.

Guest Services

- 24 hour reception
- 24 hour room service
- 6 day laundry and dry cleaning services (exc. public holidays)
- 24 hour concierge with valet car parking
- Business centre – Broadband Internet access
- Complimentary WI-FI
- Guest laundry
- Fitness centre
- Facilities for the disabled
- Currency exchange
- 2 heated resort swimming pools
- Resort pool bar
- Sauna
- 3 outdoor spas

World-class Accommodation

The Hotel offers 300 guest rooms and suites with resort-style facilities. Special conference rates are available.

Dining and Bars

The Harbour Master

Experience great service and a fantastic seasonal menu featuring a delicious grill selection, fresh seafood and tapas complimented by a walk-in wine cellar. Cosy up inside, book a private lunch or dinner in the Calista Room or relax in the sunny alfresco area overlooking the park.

Atrium Garden Restaurant

Enjoy fresh seafood, crisp salads, hot international dishes, and tempting desserts in the buffet restaurant for lunch and dinner. Try a fresh new approach to breakfast – RISE combines the best of contemporary hotel breakfast with the latest café offerings.

Marine Lounge Bar

Stop in for a coffee and bite to eat in the spacious and stylish bar, or stay to enjoy the extensive range of wines, beers, spirits, cocktails, aperitifs and champagne by the glass. A great spot to get work done or meet up with your colleagues for Happy Hour.

Ball & Chain

This historic pub dates back over 100 years, housing convicts before Fremantle Prison. A must see in Fremantle, get down to meet the amazing team, while you enjoy WA's widest range of Matilda Bay craft beer, tasty pub grub and extensive whiskey and spirit range.

Day Delegate Package \$85 per person per day

(Minimum 20 delegates)

- ◆ Main Plenary room hire
- ◆ Arrival tea and coffee, morning and afternoon tea, working style or buffet lunch
- ◆ Whiteboard, flip chart and screen
- ◆ Wi-Fi access



ESPLANADE HOTEL
◆ FREMANTLE ◆

by RYDGES

CHOOSE YOUR VENUE

↑
Collie Street Access

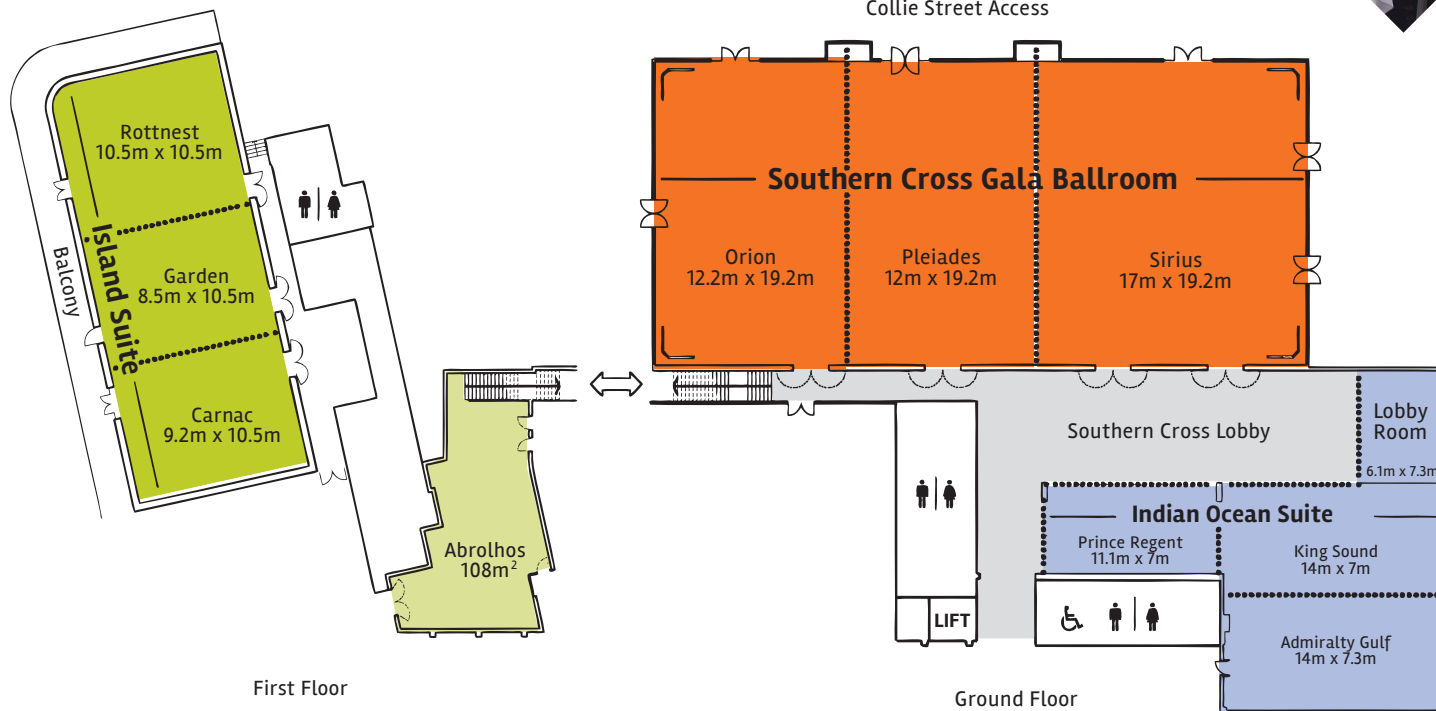

Venue Capacities

| Room | Area (sq m) | Height (metres) | Theatre style | Class-room | Work-shop | U-Shape | Hollow Square | Board Room | Cocktail | Banquet | Banquet Dance Floor | Booth 2x3m |
|------------------------------|-------------|-----------------|---------------|------------|-----------|---------|---------------|------------|----------|---------|---------------------|------------|
| Southern Cross Gala Ballroom | 799 | 6 | 1000 | 440 | 560 | n/a | n/a | n/a | 1000 | 700 | 590 | 54 |
| Sirius | 330 | 6 | 340 | 216 | 200 | 58 | 76 | n/a | 340 | 250 | 220 | 20 |
| Pleiades | 231 | 6 | 236 | 120 | 144 | 52 | 64 | n/a | 236 | 180 | 140 | 16 |
| Orion | 238 | 6 | 236 | 120 | 144 | 52 | 64 | n/a | 236 | 180 | 140 | 16 |
| Indian Ocean Suite | 261 | 2.7 | n/a | n/a | 128 | n/a | n/a | n/a | 250 | 140 | 120 | 17 |
| Prince Regent | 61 | 2.7 | 40 | 24 | 24 | n/a | n/a | 20 | 40 | 30 | n/a | 4 |
| King Sound | 98 | 2.7 | 70 | 36 | 48 | 25 | 30 | 30 | 70 | 60 | 40 | 7 |
| Admiralty Gulf | 102 | 2.7 | 70 | 36 | 48 | 25 | 30 | 30 | 70 | 60 | 40 | n/a |
| Island Suite | 322 | 2.9 | 240 | 140 | 160 | n/a | n/a | n/a | 240 | 200 | 160 | 17 |
| Rottnest Room | 121 | 2.9 | 90 | 60 | 56 | 26 | 34 | 30 | 100 | 70 | 50 | 8 |
| Garden Room | 97 | 2.9 | 80 | 50 | 40 | 20 | 28 | 20 | 80 | 50 | 30 | 6 |
| Carnac Room | 100 | 2.9 | 70 | 40 | 40 | 20 | 28 | 20 | 80 | 50 | 30 | 7 |
| Abrolhos Room | 108 | 2.7 | 60 | n/a | 32 | 24 | n/a | 24 | 100 | 50 | n/a | n/a |

Additional Venues

| Room | Boardroom | Banquet | Cocktail |
|-----------------|-----------|---------|----------|
| Resort Poolside | n/a | 220 | 400 |
| Australia II | 10 | n/a | n/a |
| Leeuwin II | 6 | n/a | n/a |

Visit www.rydges.com/fremantle Call 08 9432 4801 or email functions_esplanadefremantle@rydges.com
 Corner Marine Terrace and Essex Street, Fremantle, WA ABN 69 160 752 670